

SUPPLEMENTAL INSTRUCTION

Angelo State University

TO:

SI in Springtime

The Office of Supplemental Instruction (SI) offers a new group of SI Leaders as well as a new group of SI-supported classes for spring 2008.

We would like to welcome our new SI Leaders — Jason Bodiford (BIO 1411), Matt Jackson (BIO 2423/Lecture), Erica Schalek (BIO 2423/Lab), Katy Kirchhoff (CHEM 1412), and Heather Guthrie (GOVT 2302). Along with returning veterans — Anna Romero (BIO 2424/Lecture & Lab), Chelsea Preas (HIST 1302), and Anna Ermakova (MATH 1302) — all of the SI Leaders completed the two-day SI Training & Orientation. This intensive training was held in early January, prior to the start of the spring term, so all of the SI Leaders were ready to work on the first day of classes.

Typically SI supports courses that the University considers historically difficult—courses with a high rate of failure and withdrawal. This term we also welcome a new discipline to our spring docket: Chemistry. Following is the spring lineup of SI support:

- BIO 1411: Man & the Environment
Dr. Michael Dixon
- BIO 2423: Human Anatomy
Dr. Wilke
- BIO 2424: Human Physiology
Mr. Michael Griffin
- CHEM 1412: General Chemistry
Dr. David Carter
- HIST 1302: History/From 1865—Present
Dr. James Hindman
- GOVT 2302: Federal & State Government
Dr. Roberto Garza
- MATH 1302: College Algebra
Dr. Andrew Siefker

Each SI session is tailored to fit the supported class and lecture. Students who attend SI benefit from small group study which integrates study skills with course content.

Refer to page 2 for the spring 2008 master SI Session Schedule. Students interested in more information about Supplemental Instruction (SI) may contact the Center for Academic Excellence or surf the web. (See our contact info below.)

Below are our Spring '08 SI Leaders (1st row L to R) — Matt Jackson, Erica Schalek, and Chelsea Preas (2nd row L to R) — Heather Guthrie, Katy Kirchhoff, and Jason Bodiford, (3rd row L to R) — Anna Ermakova and Anna Romeo.



Important Dates:

- February 11—15: SI Peer Observation Due
- February 18—22: 1st SI Leader Portfolio Review



SI Staff

Dr. Susan L. Neste
Executive Director
Center for Academic Excellence
susan.neste@angelo.edu

Sara Weertz
Director
Supplemental Instruction
sara.weertz@angelo.edu

Albert Fierro
Editor
Assistant SI Coordinator
albert.fierro@angelo.edu

Office of Supplemental Instruction
Center for Academic Excellence
Library A312
(325) 942-2710
www.angelo.edu/dept/si



Katy Kirchhoff
Chemistry 1412

Spotlight on SI Leaders

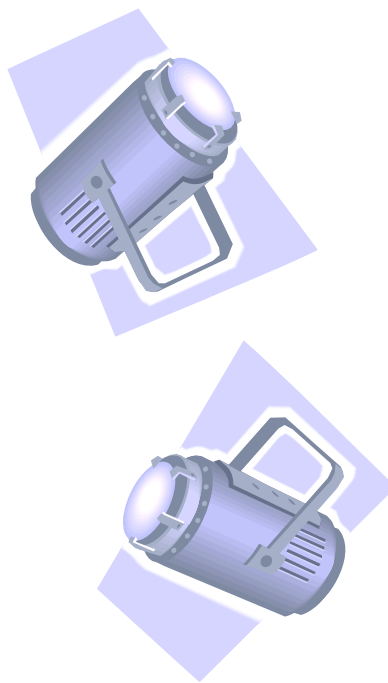

Jason Bodiford
Biology 1411

Katy Kirchhoff is a junior Chemistry major with a minor in Physics. This is her first semester as an SI Leader supporting the general chemistry sequence CHEM 1411 (fall term) and CHEM 1412 (spring term) with Dr. David Carter. Besides SI, Katy is an ASU cheerleader. Katy became an SI Leader because she has a "passion for helping others learn." When Katy graduates, she would like to teach high school chemistry and physics; she also plans to attend graduate school.

Jason Bodiford is a senior Biology major with a Chemistry minor. This is his first semester as an SI Leader supporting BIO 1411: Man & the Environment with Dr. Michael Dixon. Jason became an SI Leader "to help students better understand biology." On campus, Jason is President of the Honors Student Association and a Tri-Beta officer. Off campus, Jason is a gymnastics coach and nationally-rated judge. Jason will graduate in May 2008 and after that he's on his way to medical school.

SI Session Schedule: Spring 2008

<p>BIO 1411 Man & the Environment <u>Jason Bodiford</u> <i>jbodiford@angelo.edu</i></p> <p>M 3:00—4:00p.m. in CAV 219 T 12:30—1:30p.m. in CAV 219 W 1:00—2:00p.m. in CAV 119</p>	<p>HIST 1302 1865 to Present <u>Chelsea Preas</u> <i>cpreas@angelo.edu</i></p> <p>W 2:00—3:00p.m. in A239 TR 2:30—3:45p.m. in A235 F 3:00—4:00p.m. in A235</p>	<p>MATH 1302 College Algebra <u>Anna Ermakova</u> <i>aermakova@angelo.edu</i></p> <p>T 7:00—8:30p.m. in MCS 112 TR 4:00—5:30p.m. in MCS 112 F 2:30—4:00p.m. in MCS 112</p>	<p>GOVT 2302 Federal & State Government <u>Heather Guthrie</u> <i>hguthrie@angelo.edu</i></p> <p>M 8:00—9:00a.m. in RAS 100 T 2:00—3:00p.m. in RAS 103 W 3:00—4:00p.m. in RAS 103</p>
<p>BIO 2424 Human Physiology (LAB & LECTURE) <u>Anna Romero</u> <i>aromero1@angelo.edu</i></p> <p>M 12:30—1:30p.m. in SIII 107 W 2:30—3:30p.m. in SIII 109 F 12:00—1:00p.m. in SIII 107</p>	<p>BIO 2423 Human Anatomy (LAB) <u>Erica Schalek</u> <i>eschalek@angelo.edu</i></p> <p>M 4:00—5:00p.m. in CAV 131 T 1:00—2:00p.m. in CAV 131 W 5:00—6:00p.m. in CAV 131 F 2:00—3:00p.m. in CAV 131 <i>Fallback location: CAV 119</i></p>	<p>BIO 2423 Human Anatomy (LECTURE) <u>Matt Jackson</u> <i>mjackson7@angelo.edu</i></p> <p>M 12:00—1:00p.m. in CAV125 M 2:00—3:00p.m. in CAV 125 T 4:30—5:30p.m. in CAV 123 W 1:00—2:00p.m. in CAV 111 F 9:00—10:00a.m. in CAV 119</p>	<p>CHEM 1412 General Chemistry <u>Katy Kirchhoff</u> <i>kkirchhoff@angelo.edu</i></p> <p>M 7:00—8:00p.m. in CAV 219 T 2:00—3:00p.m. in CAV 219 TR 11:00—12:00p.m. CAV 219</p>